



rtc[®]

COUPLING TECHNOLOGY



013

rtc TYPE



DN 7.5 & 13 mm Japanese Profile Pneumatic Coupling

TYPE 013



Compatibility - Kompatibilität

rtc 464.08
Rectus 03, 13KA
Nitto-Kohki Hi Cupla
Cejn 314 / 315

Temperature Range - Temperaturbereich

Nitrile (N) -20°C + 100°C (- 4°F + 212°F)
FPM (V) -20°C + 180°C (- 4°F + 356°F)
EPDM (Ethylene Propylene) -40°C + 150°C (- 40°F + 302°F)

Working Pressure - Betriebsdruck

35 Bar (510 PSI)

Flow size - Nennweite

rtc type 013.08 7.5 mm
rtc type 013.13 13 mm

Material of Standard version / Material für die Standardversion

Socket body - Kupplungsgrundkörper	Brass with nickel plated - Messing vernickelt
Sleeve - Hülse	Steel nickel plated - Stahl Nickel beschichtet
Springs - Federn	Stainless Steel - Edelstahl
Balls - Kugeln	Stainless Steel - Edelstahl
Seals - Dichtung	Nitrile (N)
Plug - Nippel	Steel zinc-nickel plated - Stahl Zink-Nickel beschichtung

Technical Specifications and Advantages

- Japanese industrial profile.
- High performance valve with increased flow rate and minimised pressure loss.
- Advantage of one hand operation.
- Corrosion resistant.

Technische Daten und Vorteile

- Japanisches Industrieprofil.
- Ventil mit hohem Durchfluss und geringem Druckverlust.
- Vorteil durch Einhandbedienung.
- Korrosionsbeständig.



Flow Rate vs Pressure Drop Graph

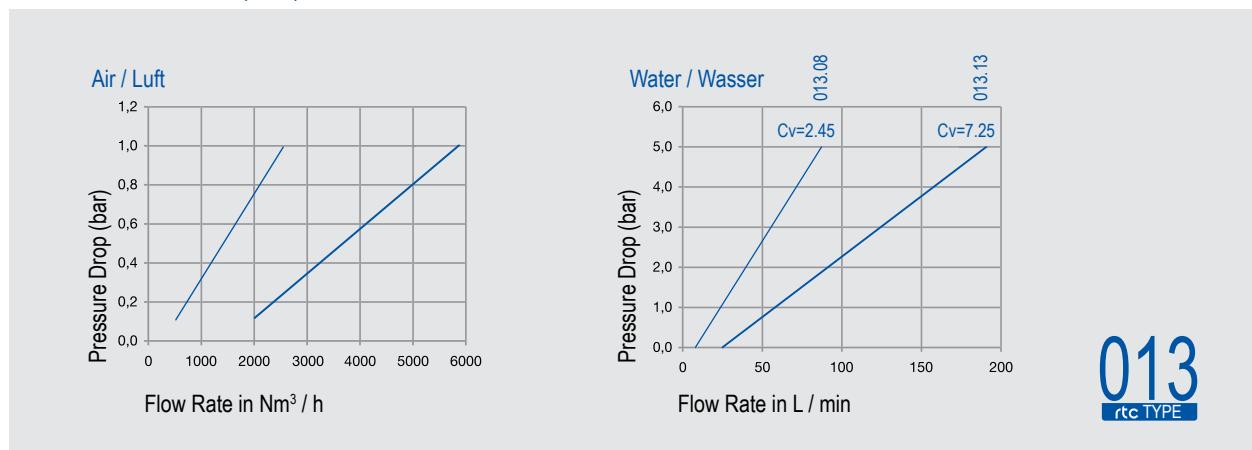

013
rtc TYPE

rtc TYPE 013

Male thread socket / Kupplung mit Aussengewinde



Socket / Kupplung

Size / Größe

Order No / Bestellnr.

Order No / Bestellnr.

Ød

Ød1

L

L1

HEX.

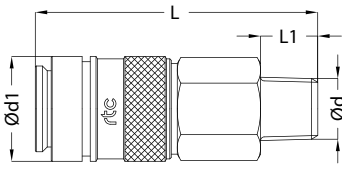

7.5

013.08 SRO 13

013.08 SRF 13

BSPT 1/4

24

58

12

22

013.08 SRO 17

013.08 SRF 17

BSPT 3/8

24

58

12

22

013.08 SRO 21

013.08 SRF 21

BSPT 1/2

24

59

17

22

13

013.13 SRO 21

013.13 SRF 21

BSPT 1/2

35

65

17

30

013.13 SRO 26

013.13 SRF 26

BSPT 3/4

35

69

19

35

013.13 SRO 33

013.13 SRF 33

BSPT 1

35

72

22

35

rtc TYPE 013

Female thread socket / Kupplung mit Innengewinde



Socket / Kupplung

Size / Größe

Order No / Bestellnr.

Order No / Bestellnr.

Ød

Ød1

L

HEX.

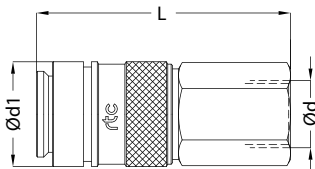

7.5

013.08 SFO 13

013.08 SFF 13

BSP 1/4

24

55

22

013.08 SFO 17

013.08 SFF 17

BSP 3/8

24

55

22

013.08 SFO 21

013.08 SFF 21

BSP 1/2

24

58

24

13

013.13 SFO 21

013.13 SFF 21

BSP 1/2

35

58

30

013.13 SFO 26

013.13 SFF 26

BSP 3/4

35

63

32

013.13 SFO 33

013.13 SFF 33

BSP 1

35

70

41

rtc TYPE 013

Standard hose tail socket / Kupplung mit gerader Standard - Schlauchtülle



Socket / Kupplung

Size / Größe

Order No / Bestellnr.

Order No / Bestellnr.

Ød

Ød1

L

L1

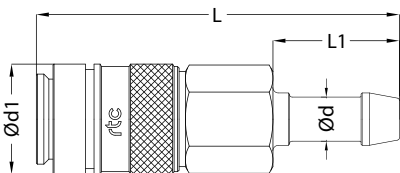

7.5

013.08 SHO 06

013.08 SHF 06

6 mm

24

69

23

013.08 SHO 08

013.08 SHF 08

8 mm

24

69

23

013.08 SHO 09

013.08 SHF 09

9 mm

24

69

23

013.08 SHO 10

013.08 SHF 10

10 mm

24

69

23

013.08 SHO 13

013.08 SHF 13

13 mm

24

69

23

13

013.13 SHO 13

013.13 SHF 13

13 mm

35

78

30

013.13 SHO 16

013.13 SHF 16

16 mm

35

83

35

013.13 SHO 19

013.13 SHF 19

19 mm

35

83

35

013.13 SHO 25

013.13 SHF 25

25 mm

35

83

35



Male thread plug / Nippel mit Aussengewinde

TYPE 013 **rtc**

Plug / Nippel	Size / Größe	Order No / Bestellnr. →→←←	Ød	Ød1	L	L1	HEX.
	7.5	013.08 PMF 13	BSP 1/4	13.2	41	11	14
		013.08 PMF 17	BSP 3/8	13.2	43	11	19
		013.08 PMF 21	BSP 1/2	13.2	47	14	24
		013.08 PRF 13	BSPT 1/4	13.2	42	12	14
		013.08 PRF 17	BSPT 3/8	13.2	44	12	19
		013.08 PRF 21	BSPT 1/2	13.2	50	17	22
		013.08 PTF 13	NPT 1/4	13.2	42	12	14
		013.08 PTF 17	NPT 3/8	13.2	44	12	19
	013.08 PTF 21	NPT 1/2	13.2	50	17	22	
	13	013.13 PMF 21	BSP 1/2	20	47	14	24
		013.13 PMF 26	BSP 3/4	20	49	16	32
		013.13 PMF 33	BSP 1	20	51	18	35
		013.13 PRF 21	BSPT 1/2	20	50	17	22
		013.13 PRF 26	BSPT 3/4	20	55	19	32
		013.13 PRF 33	BSPT 1	20	63	22	35
		013.13 PTF 21	NPT 1/2	20	50	17	22
013.13 PTF 26		NPT 3/4	20	55	19	32	
013.13 PTF 33	NPT 1	20	63	22	35		



Female thread plug / Nippel mit Innengewinde

TYPE 013 **rtc**

Plug / Nippel	Size / Größe	Order No / Bestellnr. →→←←	Ød	Ød1	L	HEX.
	7.5	013.08 PFF 13	BSP 1/4	13.2	43	17
		013.08 PFF 17	BSP 3/8	13.2	44	19
		013.08 PFF 21	BSP 1/2	13.2	49	27
		013.08 PNF 13	NPT 1/4	13.2	43	17
		013.08 PNF 17	NPT 3/8	13.2	44	22
		013.08 PNF 21	NPT 1/2	13.2	49	27
	13	013.13 PFF 21	BSP 1/2	20	41	27
		013.13 PFF 26	BSP 3/4	20	45	35
		013.13 PFF 33	BSP 1	20	54	41
		013.13 PNF 21	NPT 1/2	20	44	27
		013.13 PNF 26	NPT 3/4	20	48	35
		013.13 PNF 33	NPT 1	20	57	41



Standard hose tail plug / Nippel mit gerader Standard - Schlauchtülle

TYPE 013 **rtc**

Plug / Nippel	Size / Größe	Order No / Bestellnr. →→←←	Ød	Ød1	L	L1
	7.5	013.08 PHF 06	6 mm	13.2	51	23
		013.08 PHF 08	8 mm	13.2	51	23
		013.08 PHF 10	10 mm	13.2	51	23
		013.08 PHF 13	13 mm	13.2	51	23
	13	013.13 PHF 13	13 mm	20	57	30
		013.13 PHF 16	16 mm	20	62	35
		013.13 PHF 19	19 mm	20	62	35
		013.13 PHF 25	25 mm	20	64	35