



rtc[®]

COUPLING TECHNOLOGY



023

rtc TYPE



DN 5.5 mm Pneumatic Coupling

TYPE 023



Compatible - Kompatibilität

Industrial Interchange 1/4"

rtc	460.06
Rectus	23KA, 24KA, 1400/1423
Parker	20 1/4", 30 1/4"
Cejn	310
Hansen	3000
Tema	1400

Temperature Range - Temperaturbereich

Nitrile (N)	-20°C + 100°C (-4°F + 212°F)
FPM (V)	-20°C + 180°C (-4°F + 356°F)
EPDM (Ethylene Propylene)	-40°C + 150°C (-40°F + 302°F)

Working Pressure - Betriebsdruck

35 Bar (510 PSI)

Flow size - Nennweite

rtc type 023 5.5 mm

Standard version - Standardversion

Seals - Dichtung : Nitrile (N)

Material of Standard Coupler

Material für die Standardversion

Socket body - Kupplungsgrundkörper	Brass Nickel Plated - Messing vernickelt
Sleeve - Hülse	Steel Nickel Plated - Stahl vernickelt
Springs - Federn	Stainless Steel - Edelstahl
Balls - Kugeln	Stainless Steel - Edelstahl

Plug - Nippel	Steel zinc-nickel plated - Stahl Zink-Nickel beschichtet
------------------	---

Technical Specifications & Advantages

- Plug profile perfectly fits to the **ISO 6150-B-12**, **AFNOR B-12 NF E 49-053**, **US MIL C-4109**
- Advantage of one hand operation.
- High performance valve with increased flow rate and minimised pressure loss.
- Corrosion resistant.

Technische Daten und Vorteile

- Stecknippel gemäß **ISO 6150-B-12**, **AFNOR B-12 NF E 49-053**, **US MIL C-4109**
- Ventil mit hohem Durchfluss und geringem Druckverlust.
- Vorteil durch Einhandbedienung.
- Korrosionsbeständig.

Material of Brass Coupler

Material für die Messingversion

Socket body Kupplungsgrundkörper	Brass - Messing
Sleeve - Hülse	Brass - Messing
Springs - Federn	Stainless Steel - Edelstahl
Balls - Kugeln	Stainless Steel - Edelstahl

Plug - Nippel	Brass - Messing
---------------	-----------------



Flow Rate vs Pressure Drop Graph

Air / Luft

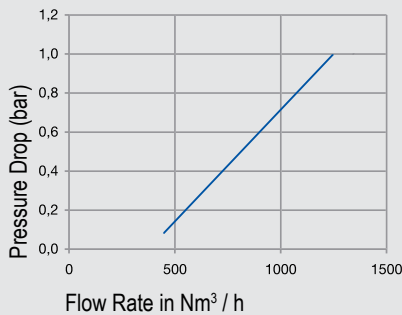

Water / Wasser

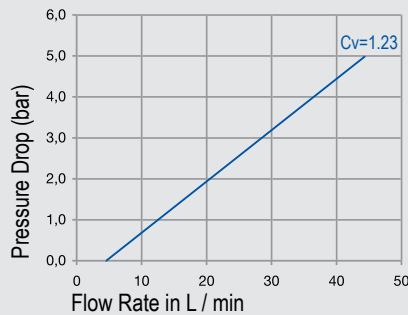

023
rtc TYPE

rtc TYPE 023

Male thread socket / Kupplung mit Aussengewinde



Sockets / Kupplungen

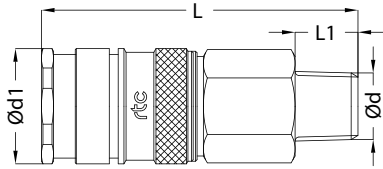

Size / Größe	Order No / Bestellnr. With valve / mit Ventil	Order No / Bestellnr. Without valve / ohne Ventil	Ød	Ød1	L	L1	HEX.
5.5	023 SRO 10	023 SRF 10	BSPT 1/8	22	57	9	19
	023 SRO 13	023 SRF 13	BSPT 1/4	22	60	12	19
	023 SRO 17	023 SRF 17	BSPT 3/8	22	59	12	19
	023 SRO 21	023 SRF 21	BSPT 1/2	22	57	17	22
	023 SMO 1415	023 SMF 1415	M14x1.5	22	58	10	19
	023 SMO 1615	023 SMF 1615	M16x1.5	22	58	11	19
	023 SMO 1815	023 SMF 1815	M18x1.5	22	58	11	19

rtc TYPE 023

Female thread socket / Kupplung mit Innengewinde



Sockets / Kupplungen

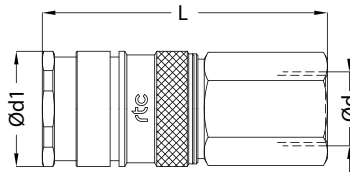

Size / Größe	Order No / Bestellnr. With valve / mit Ventil	Order No / Bestellnr. Without valve / ohne Ventil	Ød	Ød1	L	L1	HEX.
5.5	023 SFO 10	023 SFF 10	BSP 1/8	22	55	9	19
	023 SFO 13	023 SFF 13	BSP 1/4	22	55	9	19
	023 SFO 17	023 SFF 17	BSP 3/8	22	54	9	19
	023 SFO 21	023 SFF 21	BSP 1/2	22	57	12	24

rtc TYPE 023

Standard hose tail socket / Kupplung mit gerader Standard - Schlauchtülle



Sockets / Kupplungen

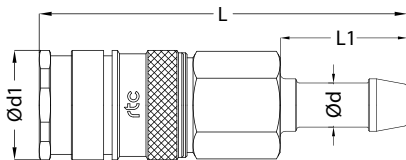

Size / Größe	Order No / Bestellnr. With valve / mit Ventil	Order No / Bestellnr. Without valve / ohne Ventil	Ød	Ød1	L	L1	HEX.
5.5	023 SHO 06	023 SHF 06	6 mm	22	70.5	22.5	19
	023 SHO 08	023 SHF 08	8 mm	22	70.5	22.5	19
	023 SHO 09	023 SHF 09	9 mm	22	70.5	22.5	19
	023 SHO 10	023 SHF 10	10 mm	22	70.5	22.5	19
	023 SHO 13	023 SHF 13	13 mm	22	70.5	22.5	19

rtc TYPE 023

Socket with plastic hose connection / Kupplung mit Kunststoffschlauch



Sockets / Kupplungen

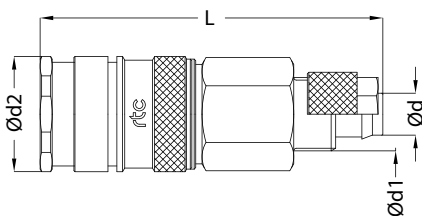

Size / Größe	Order No / Bestellnr. With valve / mit Ventil	Order No / Bestellnr. Without valve / ohne Ventil	Ød	Ød1	Ød2	L	HEX.
5.5	023 SVO 0608	023 SVF 0608	6x8 mm	M12x1	16	61	19
	023 SVO 0810	023 SVF 0810	8x10 mm	M16x1	16	65	19

Male thread plug / Nippel mit Aussengewinde TYPE 023 **rtc**

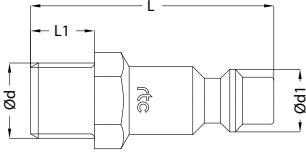
Plugs / Nippel	Size / Größe	Order No / Bestellnr. Without valve / ohne Ventil	Ød	Ød1	L	L1	HEX.
	5.5	023 PMF 10	BSP 1/8	8	39.5	9	14
		023 PMF 13	BSP 1/4	8	42.5	12	14
		023 PMF 17	BSP 3/8	8	45.5	12	17
		023 PMF 21	BSP 1/2	8	51.5	17	22
		023 PRF 10	BSPT 1/8	8	36.5	8	14
		023 PRF 13	BSPT 1/4	8	40.5	11	14
		023 PRF 17	BSPT 3/8	8	42	11	19
		023 PRF 21	BSPT 1/2	8	47.5	13	22

Brass / Messing Kindly add "MS"
at the end of the order no
Example code: 023 PMF 10 MS

Female thread plug / Nippel mit Innengewinde TYPE 023 **rtc**

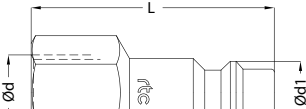
Plugs / Nippel	Size / Größe	Order No / Bestellnr. Without valve / ohne Ventil	Ød	Ød1	L	L1	HEX.
	5.5	023 PFF 10	BSP 1/8	8	37.5	9	13
		023 PFF 13	BSP 1/4	8	40.5	12	17
		023 PFF 17	BSP 3/8	8	41.5	12	19
		023 PFF 21	BSP 1/2	8	46	14	24

Brass / Messing Kindly add "MS"
at the end of the order no
Example code: 023 PFF 10 MS

Standard hose tail plug / Nippel mit gerader Standard - Schlauchtülle TYPE 023 **rtc**

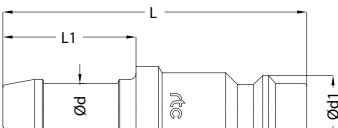
Plugs / Nippel	Size / Größe	Order No / Bestellnr. Without valve / ohne Ventil	Ød	Ød1	L	L1
	5.5	023 PHF 06	6 mm	8	49	23
		023 PHF 08	8 mm	8	49	23
		023 PHF 09	9 mm	8	49	23
		023 PHF 10	10 mm	8	49	23
		023 PHF 13	13 mm	8	49	23

Brass / Messing Kindly add "MS"
at the end of the order no
Example code: 023 PHF 06 MS