



# rtc<sup>®</sup>

COUPLING TECHNOLOGY



# 071

rtc TYPE



**Compatible - Kompatibilität**  
Snap-Tite 71

**Temperature Range - Temperaturbereich**  
-20°C +100°C (-4°F +212°F) Nitril (N)  
-10°C +180°C (+14°F +356°F) FPM (V)

**Max. Working Pressure - Max. Betriebsdruck**  
On the table / Siehe Tabelle pg 126

**Flow size - Nennweiten**

rtc 071.06	6 mm
rtc 071.09	9 mm
rtc 071.13	13 mm
rtc 071.19	19 mm
rtc 071.25	25 mm
rtc 071.30	30 mm

**Material of Stainless Steel Coupler**  
**Material für die Edelstahlversion**

Socket body - Kupplungsgrundkörper	Stainless Steel - Edelstahl
Sleeve - Hülse	Stainless Steel - Edelstahl
Springs - Federn	Stainless Steel - Edelstahl
Locking Ring - Sprengring	Stainless Steel - Edelstahl
Balls - Kugeln	Stainless Steel - Edelstahl
Seals - Dichtungen	Nitrile (N)

Plug - Nippel Stainless Steel - Edelstahl

**Material of Steel Coupler**  
**Material für die Stahlversion**

Socket body - Kupplungsgrundkörper	Steel nickel plated - Stahl Nickel beschichtet
Sleeve - Hülse	Steel nickel plated - Stahl Nickel beschichtet
Springs - Federn	Stainless Steel - Edelstahl
Locking Ring - Sprengring	Stainless Steel - Edelstahl
Balls - Kugeln	Stainless Steel - Edelstahl
Seals - Dichtungen	Nitrile (N)

Plug - Nippel Steel nickel plated - Stahl Nickel beschichtet

**Advantages**

- High Flow
- Flat Face
- Stainless Steel version
- High Pressure Stainless Steel version
- Heavy Duty

**Vorteil**

- Hohe Durchflussrate
- Flat Face
- Edelstahl Ausführung
- Hochdruck-Edelstahl Ausführung
- Schwere Ausführung

**Applications**

- Connection of hydraulic pumps, valves and quick tool change.
- Aluminium die casting.
- Test benches.
- Plastic industry tool changing.
- Steel industry.

**Anwendungen**

- Verbindung von Hydraulikpumpen und Ventile für schnellen Werkzeugwechsel
- Aluminiumdruckguss
- Prüfstände
- Werkzeugwechsel in der Kunststoffindustrie
- Stahlindustrie



Options / Optionen	Add	Example Code
Steel Stahl	ST	071.06 SFB 13- <b>ST</b>
Stainless Steel AISI 316L Edelstahl AISI 316L	S6	071.06 SFB 13- <b>S6</b>
High Pressure Stainless Steel Edelstahl AISI 303	SH6	071.06 SFB 13- <b>SH6</b>

**Flow Rate vs Pressure Drop Graph**

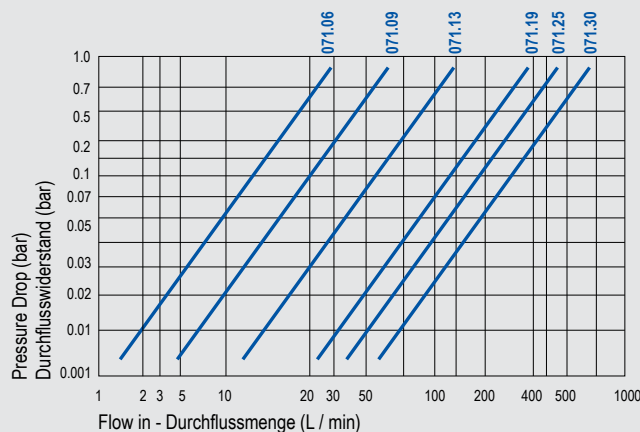

**071**  
rtc TYPE

**rtc** TYPE 071

Female thread socket / Kupplung mit Innengewinde



Socket / Kupplung

Size / Größe

Order No / Bestellnr.

Ød

Ød1

L

HEX.

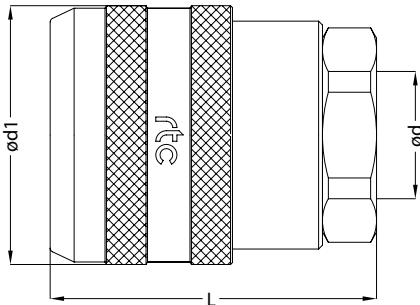

06	071.06 SFB 13	BSP 1/4	30	50	23
	071.06 SNB 13	NPT 1/4	30	50	23
09	071.09 SFB 17	BSP 3/8	40	60	30
	071.09 SNB 17	NPT 3/8	40	60	30
13	071.13 SFB 21	BSP 1/2	48	70	38
	071.13 SNB 21	NPT 1/2	48	70	38
19	071.19 SFB 26	BSP 3/4	57	77.5	44
	071.19 SNB 26	NPT 3/4	57	77.5	44
25	071.25 SFB 33	BSP 1	67	84.5	50
	071.25 SNB 33	NPT 1	67	84.5	50
30	071.30 SFB 42	BSP 1-1/4	67	93	50
	071.30 SNB 42	NPT 1-1/4	67	93	50

**rtc** TYPE 071

Female thread socket / Kupplung mit Innengewinde



Socket / Kupplung

Size / Größe

Order No / Bestellnr.

Ød

Ød1

L

HEX.

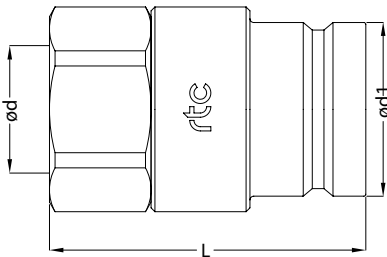

06	071.06 PFB 13	BSP 1/4	30	50	23
	071.06 PNB 13	NPT 1/4	30	50	23
09	071.09 PFB 17	BSP 3/8	40	60	30
	071.09 PNB 17	NPT 3/8	40	60	30
13	071.13 PFB 21	BSP 1/2	48	70	38
	071.13 PNB 21	NPT 1/2	48	70	38
19	071.19 PFB 26	BSP 3/4	57	77.5	44
	071.19 PNB 26	NPT 3/4	57	77.5	44
25	071.25 PFB 33	BSP 1	67	84.5	50
	071.25 PNB 33	NPT 1	67	84.5	50
30	071.30 PFB 42	BSP 1-1/4	67	93	50
	071.30 PNB 42	NPT 1-1/4	67	93	50

**rtc** TYPE 071

Technical Specifications



Working Pressure / Betriebsdruck

Body Size / Größe		High Pressure Stainless Steel Hochdruck Edelstahl		Steel nickel plated Stahl Nickel beschichtet		Standard Stainless steel Standart Edelstahl	
		Bar	PSI	Bar	PSI	Bar	PSI
071.06	1/4	690	10.000	690	10.000	345	5.000
071.09	3/8	690	10.000	690	10.000	345	5.000
071.13	1/2	690	10.000	690	10.000	345	5.000
071.19	3/4	515	7.500	515	7.500	345	5.000
071.25	1	515	7.500	515	7.500	275	4.000
071.30	1-1/4	515	7.500	515	7.500	275	4.000