



rtc[®]

COUPLING TECHNOLOGY



074

rtc TYPE



Compatible - Kompatibilität
Nitto Kohki HSP

Temperature Range - Temperaturbereich
-20°C +100°C (-4°F +212°F) Nitril (N)
-10°C +180°C (+14°F +356°F) FPM (V)

Max. Working Pressure - Max. Betriebsdruck

rtc 074.06	350 bar (5.100 PSI)
rtc 074.10	300 bar (4.350 PSI)
rtc 074.13	250 bar (3.625 PSI)
rtc 074.16	250 bar (3.625 PSI)
rtc 074.19	250 bar (3.625 PSI)
rtc 074.25	250 bar (3.625 PSI)
rtc 074.32	250 bar (3.625 PSI)
rtc 074.37	250 bar (3.625 PSI)

Flow size - Nennweiten

rtc 074.06	6 mm
rtc 074.10	10 mm
rtc 074.13	13 mm
rtc 074.16	16 mm
rtc 074.19	19 mm
rtc 074.25	25 mm
rtc 074.32	32 mm
rtc 074.37	37 mm

Material of Standard Coupler
Material für die Standardversion

Socket body - Kupplungsgrundkörper	Stainless Steel - Edelstahl
Sleeve - Hülse	Stainless Steel - Edelstahl
Springs - Federn	Stainless Steel - Edelstahl
Locking Ring - Sprengring	Stainless Steel - Edelstahl
Balls - Kugeln	Stainless Steel - Edelstahl
Seals - Dichtungen	Nitrile (N)

Plug - Nippel Stainless Steel - Edelstahl

Advantages

- High Flow
- Hardened Special Steel body
- Heavy Duty
- Full flow version is available

Vorteil

- Hohe Durchflussrate
- Körper aus gehärtetem Spezialstahl
- Schwere Ausführung
- Auch ohne Ventil erhältlich

Applications

- Connection of hydraulic pumps, valves and quick tool change.
- Aluminium die casting.
- Test benches.
- Plastic industry tool changing.
- Steel industry.

Anwendungen

- Verbindung von Hydraulikpumpen und Ventile für schnellen Werkzeugwechsel
- Aluminiumdruckguss
- Prüfstände
- Werkzeugwechsel in der Kunststoffindustrie
- Stahlindustrie



Flow Rate vs Pressure Drop Graph

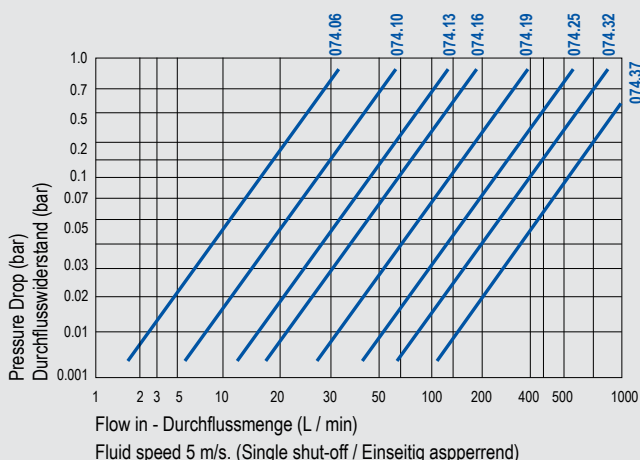

074
rtc TYPE

rtc TYPE 074

Female thread socket / Kupplung mit Innengewinde



Socket / Kupplung

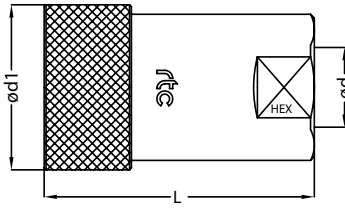

Size / Größe	Order No / Bestellnr. With Valve / Mit Ventil	Order No / Bestellnr. Without Valve / Ohne Ventil	Ød	Ød1	L	HEX.
06	074.06 SQB 13	074.06 SQF 13	BSPT 1/4	27.5	49	19
10	074.10 SQB 17	074.10 SQF 17	BSPT 3/8	33	60	23
13	074.13 SQB 21	074.13 SQF 21	BSPT 1/2	43	72	35
16	074.16 SQB 26	074.16 SQF 26	BSPT 3/4	43	72	35
19	074.19 SQB 33	074.19 SQF 33	BSPT 1	58	93	46
25	074.25 SQB 42	074.25 SQF 42	BSPT 1-1/4	87	138	58
32	074.32 SQB 48	074.32 SQF 48	BSPT 1-1/2	87	138	58
37	074.37 SQB 60	074.37 SQF 60	BSPT 2	123	198	80

rtc TYPE 074

Male thread socket / Kupplung mit Aussengewinde



Socket / Kupplung

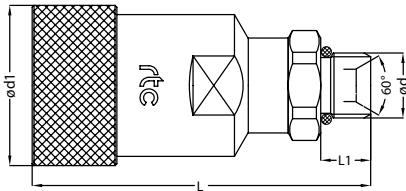

Size / Größe	Order No / Bestellnr.	Ød	Ød1	L	L1	HEX.
06	074.06 SOB 13	BSP 1/4	27.5	65	11.5	19
10	074.10 SOB 17	BSP 3/8	33	77.5	13	23
13	074.13 SOB 21	BSP 1/2	43	87.5	14.5	29
16	074.16 SOB 26	BSP 3/4	43	90	16.5	32

rtc TYPE 074

Male conical thread socket / Kupplung mit Aussengewinde konisch



Socket / Kupplung

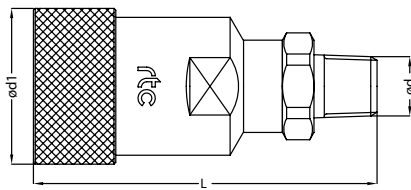

Size / Größe	Order No / Bestellnr.	Ød	Ød1	L	L1	HEX.
06	074.06 SRB 13	BSPT 1/4	27.5	66	11.5	19
10	074.10 SRB 17	BSPT 3/8	33	77.5	13	23
13	074.13 SRB 21	BSPT 1/2	43	90	14.5	29
16	074.16 SRB 26	BSPT 3/4	43	93	16.5	32

rtc TYPE 074

UNF Male thread socket with 37° sealing cone / Kupplung mit UNF Aussengewinde 37° Dichtkonus



Socket / Kupplung

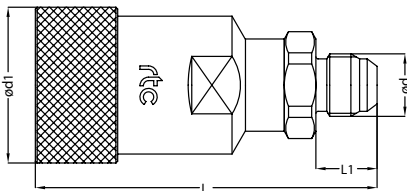

Size / Größe	Order No / Bestellnr.	Ød	Ød1	L	L1	HEX.
06	074.06 SJB 1319	BSP 1/4-19	27.5	65	11.5	19
10	074.10 SJB 1719	BSP 3/8-19	33	77.5	13	23
13	074.13 SJB 2114	BSP 1/2-14	43	87.5	14.5	29
16	074.16 SJB 2614	BSP 3/4-14	43	90	16.5	32

rtc TYPE 074

Female thread plug / Nippel mit Innengewinde



Plugs / Nippel

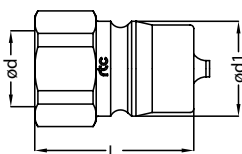

Size / Größe	Order No / Bestellnr. With Valve / Mit Ventil	Order No / Bestellnr. Without Valve / Ohne Ventil	Ød	Ød1	L	HEX.
06	074.06 PQB 13	074.06 PQF 13	BSPT 1/4	16	32	19
10	074.10 PQB 17	074.10 PQF 17	BSPT 3/8	20	38	23
13	074.13 PQB 21	074.13 PQF 21	BSPT 1/2	26	44	29
16	074.16 PQB 26	074.16 PQF 26	BSPT 3/4	30	50	32
19	074.19 PQB 33	074.19 PQF 33	BSPT 1	39	61	41
25	074.25 PQB 42	074.25 PQF 42	BSPT 1-1/4	56	80	58
32	074.32 PQB 48	074.32 PQF 48	BSPT 1-1/2	56	80	58
37	074.37 PQB 60	074.37 PQF 60	BSPT 2	53.5	115	90



Male thread plug / Nippel mit Aussengewinde

TYPE 074



Plugs / Nippel

Size / Größe

Order No / Bestellnr.

Ød

Ød1

L

L1

HEX.

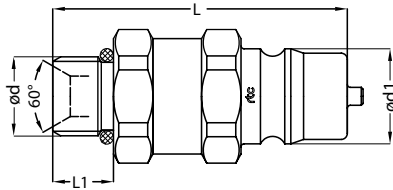

06	074.06 POB 13	BSP 1/4	16	48	11.5	19
10	074.10 POB 17	BSP 3/8	20	55.5	13	23
13	074.13 POB 21	BSP 1/2	26	60.5	14.5	29
16	074.16 POB 26	BSP 3/4	30	63.5	16.5	32



Male conical thread plug / Nippel mit Aussengewinde konisch

TYPE 074



Plug / Nippel

Size / Größe

Order No / Bestellnr.

Ød

Ød1

L

L1

HEX.

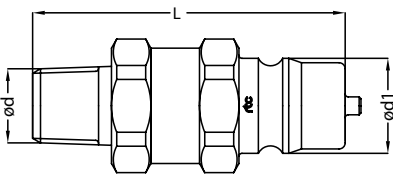

06	074.06 PRB 13	BSPT 1/4	16	49	11.5	19
10	074.10 PRB 17	BSPT 3/8	20	55.5	13	23
13	074.13 PRB 21	BSPT 1/2	26	63	14.5	29
16	074.16 PRB 26	BSPT 3/4	30	66	16.5	32



UNF Male thread plug with 37° sealing cone / Nippel mit UNF Aussengewinde 37° Dichtkonus

TYPE 074



Plugs / Nippel

Size / Größe

Order No / Bestellnr.

Ød

Ød1

L

L1

HEX.

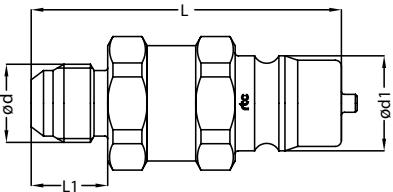

06	074.06 PJB 1319	BSP 1/4-19	16	48	11.5	19
10	074.10 PJB 1719	BSP 3/8-19	20	55.5	13	23
13	074.13 PJB 2114	BSP 1/2-14	26	60.5	14.5	29
16	074.16 PJB 2614	BSP 3/4-14	30	63.5	16.5	32