

**rtc** TYPE MHN HT1

Male thread Push to connect hose connect / Aussengewinde Schnellsteck Schlauchtülle

Adapter / Nippel

Material: Brass - Messing  
Plating: Nickel

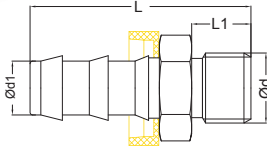

Order No / Bestellnr.	Ød	Ød1	L	L1	HEX.
MHN 10-06 HT1	BSP 1/8	6	39	7	14
MHN 10-10 HT1	BSP 1/8	10	39	7	14
MHN 13-06 HT1	BSP 1/4	6	39	9	17
MHN 13-10 HT1	BSP 1/4	10	39	9	17
MHN 13-13 HT1	BSP 1/4	13	39	9	17
MHN 17-10 HT1	BSP 3/8	10	39	9	19
MHN 17-13 HT1	BSP 3/8	13	43	9	19
MHN 21-10 HT1	BSP 1/2	10	43	10	22
MHN 21-13 HT1	BSP 1/2	13	43	10	22
MHN 21-16 HT1	BSP 1/2	16	58	10	22
MHN 26-16 HT1	BSP 3/4	16	62	16	27
MHN 26-19 HT1	BSP 3/4	19	62	16	27
MHN 33-19 HT1	BSP 1	19	69	19	35
MHN 33-25 HT1	BSP 1	25	69	20	35
MHN 1010-10 HT1	M10x1	10	39	7	11
MHN 1415-13 HT1	M14x1.5	13	39	9	15

**rtc** TYPE MHN HT2

Male thread hose connect / Aussengewinde Schlauchtülle

Adapter / Nippel

Material: Brass - Messing  
Plating: Nickel

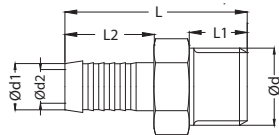

Order No / Bestellnr.	Ød	Ød1	Ød2	L	L1	L2	HEX.
MHN 10-09 HT2	BSP 1/8	9	6	33.5	7	22.5	11
MHN 13-09 HT2	BSP 1/4	9	6	37.5	9	25	15
MHN 13-13 HT2	BSP 1/4	13	8	40	9	22.5	15
MHN 17-09 HT2	BSP 3/8	9	6	37.5	9	25	17
MHN 17-13 HT2	BSP 3/8	13	9	40	9	25	17
MHN 21-19 HT2	BSP 1/2	19	13	50	12	35	22
MHN 26-19 HT2	BSP 3/4	19	13	56	16	35	27
MHN 1010-09 HT2	M10x1	9	6	33.5	9	22.5	11
MHN 1215-13 HT2	M12x1.5	13	7	40	9	25	15
MHN 1415-13 HT2	M14x1.5	13	9	40	9	25	15
MHN 1615-13 HT2	M16x1.5	13	9	40	9	25	17
MHN 2415-19 HT2	M24x1.5	19	13	56	16	35	27

**rtc** TYPE MHN HT6

Male thread hose connect / Aussengewinde Schlauchtülle

Adapter / Nippel

Material: Brass - Messing  
Plating: Nickel

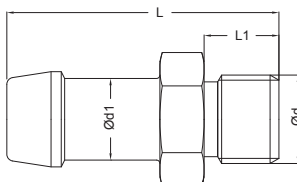

Order No / Bestellnr.	Ød	Ød1	L	L1	HEX.
MHN 10-04 HT6	BSP 1/8	4	38	8	14
MHN 10-06 HT6	BSP 1/8	6	38	8	14
MHN 10-08 HT6	BSP 1/8	8	43	8	14
MHN 10-10 HT6	BSP 1/8	10	43	8	14
MHN 13-06 HT6	BSP 1/4	6	41	11	17
MHN 13-08 HT6	BSP 1/4	8	46	11	17
MHN 13-09 HT6	BSP 1/4	9	46	11	17
MHN 13-10 HT6	BSP 1/4	10	46	11	17
MHN 13-13 HT6	BSP 1/4	13	51	11	17
MHN 17-08 HT6	BSP 3/8	8	47	12	19
MHN 17-10 HT6	BSP 3/8	10	47	12	19
MHN 17-13 HT6	BSP 3/8	13	52	12	19
MHN 17-16 HT6	BSP 3/8	16	52	12	18
MHN 21-13 HT6	BSP 1/2	13	54	14	23
MHN 21-16 HT6	BSP 1/2	16	54	14	23
MHN 26-16 HT6	BSP 3/4	16	58	16	23



Adapter / Nippel

Material: Steel - Stahl  
Plating: Zinc

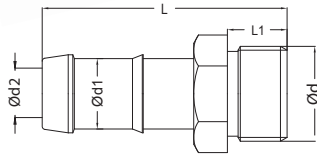

Order No / Bestellnr.	Ød	Ød1	Ød2	L	L1	HEX.
MHN 17-13 HT8	BSP 3/8	13	9	59	12	19
MHN 17-16 HT8	BSP 3/8	16	11	59	12	23
MHN 21-13 HT8	BSP 1/2	13	9	61	14	23
MHN 21-16 HT8	BSP 1/2	16	11	61	14	23
MHN 21-19 HT8	BSP 1/3	19	11	61	14	23
MHN 26-19 HT8	BSP 3/4	19	15	65	16	29
MHN 26-25 HT8	BSP 3/4	25	19	80	16	35
MHN 33-19 HT8	BSP 1	19	15	84	20	35
MHN 33-25 HT8	BSP 1	25	19	84	20	35